

Product Specifications

Backing Flanges

Moulded

Type : Slip-on

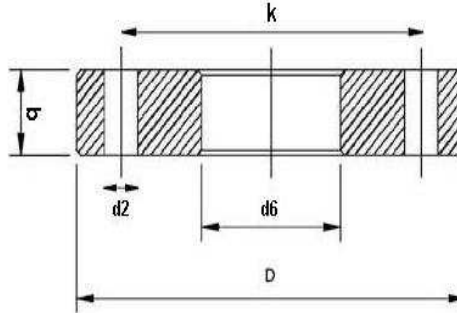

Dimensions in mm

Code	ASA 150lbs, ANSI 16.5							BS 10 Table D					
	d	d6	K	D	b	d2	Bolts	d6	K	D	b	d2	Bolts
PEFS020	20	25	60	90	20	16	4 X M14	25	67	95	20	14	4 x 1/2"
PEFS025	25	30	70	100	20	16	4 X M14	30	73	102	20	14	4 x 1/2"
PEFS032	32	40	80	108	20	16	4 X M14	40	83	115	20	14	4 x 1/2"
PEFS040	40	50	89	118	20	16	4 X M14	50	87	120	20	14	4 x 1/2"
PEFS050	50	60	99	127	20	16	4 X M14	60	98	134	20	14	4 x 1/2"
PEFS063	63	73	121	153	20	19	4 X M16	73	115	152	20	14	4 x 1/2"
PEFS075	75	85	140	178	20	19	4 X M16	85	127	165	20	18	4 x 1/2"
PEFS090	90	100	152	191	20	19	4 X M16	100	146	184	20	18	8 x 5/8"
PEFS110	110	120	191	229	22	19	8 X M16	120	178	216	20	18	8 x 5/8"
PEFS125	125	135	216	254	22	23	8 X M21	135	210	254	20	18	8 x 5/8"
PEFS140	140	150	216	254	22	23	8 X M21	150	210	254	20	18	8 x 5/8"
PEFS160	160	170	241	280	24	23	8 X M21	170	235	280	20	18	8 x 5/8"
PEFS180	180	190	241	310	24	23	8 X M21	190	260	305	20	18	8 x 5/8"
PEFS200	200	210	299	343	26	23	8 X M21	210	261	305	25	18	8 x 5/8"
PEFS225	225	235	299	343	26	23	8 X M21	235	292	337	25	18	8 x 5/8"
PEFS250	250	265	362	406	30	26	12 X M24	265	356	406	30	18	8 x 5/8"
PEFS280	280	295	362	406	30	26	12 X M24	295	356	406	30	21	8 x 3/4"
PEFS315	315	330	432	483	30	26	12 X M24	330	406	457	30	21	12 x 3/4"
PEFS355	355	370	476	534	30	26	12 X M24	370	470	527	30	21	12 x 3/4"
PEFS400	400	415	540	597	35	29	12 X M26	415	521	576	35	24	12 x 7/8"
PEFS450	450	465	578	635	35	29	16 X M26	465	584	641	35	24	12 x 7/8"
PEFS500	500	515	635	700	35	32	16 X M30	515	641	705	35	24	16 x 7/8"
PEFS560	560	575	692	749	35	35	20 X M32	575	699	762	35	28	16 x 1"
PEFS630	630	645	749	814	35	35	20 X M32	645	756	825	35	28	16 x 1"

Galvanized Steel, Stainless Steel Flanges available. Table E & Table F & also HDPE Flanges with Steel Inserts as per DIN 2501 available